



TUI BLUE
TUI BLUE
Khao Lak Resort



Opening Date: 2012 214 Rooms

Attractions/Other Destinations

Khao Lak Beach	0 m
Khao Lak Center	600 m
Khao Lak Lamru National Park	600 m
Bang Niang Market	3.5 km
Thap Lamu Pier	9 km
Phang-nga Town	65 km
Phuket Airport	80 km

Photos: www.flickr.com/photos/khaolakbeachfront/albums/72157664730497589



26/15 Moo 7, Petchkasem Road, Khao Lak Beach, Khuekkhak, Takuapa, Phang-nga 82220 - Thailand

Tel: +66 76 428 900

Fax: +66 76 428 906

Email: info@tuibluekhaolak.com

Web: www.tuibluekhaolak.com



Everything you could possibly want in a tropical getaway is just a stone's throw away.

Facilities & Services

- 5 Swimming Pools
- 2 Restaurants
- 1 Beach Bar
- 1 Swim-up Pool Bar
- Air-conditioned Lobby
- 24 Hours Reception
- Room Service
- Fitness Room & Wellness Facilities
- Spa by The Sun Spa
- Laundry Services
- Luggage Room
- Pool Table
- Table Tennis
- Water Sport Activities
- Internet Service and WiFi Hotspot
- Excursions & Tour Service
- Currency Exchange
- Check-in/out Waiting Lounge
- Airport Transfer
- Taxi Service
- Car Rental
- Car Park

Accommodation

The hotel's rooms and bungalows are equipped to the highest standard. Each room is comfortably decorated in a Malays-inspired Thai style. Guest room amenities include private balcony / terrace, air conditioning, shower / bathtub, hair dryer, large flat screen with satellite TV, working desk, big size fridge, safety box, coffee / tea making facilities and Internet Connection (WiFi access).

Deluxe

88 rooms
 Room Size 44 sq.m.
 Location/View: Garden View or Pool View at 1st - 2nd Floor
 Bedding: 1 King or 2 Singles



Deluxe Pool Access

20 rooms
 Room Size 44 sq.m.
 Location/View: Pool View at Ground Floor
 Bedding: 1 King or 2 Singles



Deluxe Corner

12 rooms
 Room Size 55 sq.m.
 Location/View: Garden View or Pool View at Ground - 2nd Floor
 Bedding: 1 King + 1 Single or 1 King + 2 Singles



Deluxe Bungalow

14 rooms
 Room Size 52 sq.m.
 Location/View: Garden View or Pool View at Ground Floor
 Bedding: 1 King or 2 Singles



Deluxe Bungalow Beachfront

14 rooms
 Room Size 35 - 42 sq.m.
 Location/View: Sea View at Ground Floor
 Bedding: 1 King or 2 Singles



Grand Deluxe

66 rooms
 Room Size 44 sq.m.
 Location/View: Sea View or Pool View at Ground Floor
 Bedding: 1 King or 2 Singles

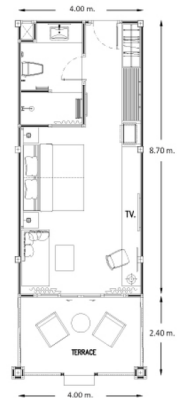

Room Configuration Policy

- Maximum of 2 adults in all room types.
- Maximum of 4 adults in Deluxe Corner room type. (Extra charge applies to 3rd and 4th adult)
- All rooms are equipped with sofa bed. (No extra bed/rollaway beds provided)

Adults only policy: The guest must be 16 yrs. old and above.